



# KING KING CANADA

## WET•DRY VACUUM



MODEL: 8560LST

# INSTRUCTION MANUAL

COPYRIGHT © 2008 ALL RIGHTS RESERVED BY KING CANADA TOOLS INC.



## WARRANTY INFORMATION & SAFETY RULES FOR WET•DRY VACUUMS

**2-YEAR  
LIMITED WARRANTY  
FOR THIS WET•DRY VACUUM**

**KING CANADA TOOLS  
OFFERS A 2-YEAR LIMITED WARRANTY  
FOR NON-COMMERCIAL USE.**

### **PROOF OF PURCHASE**

Please keep your dated proof of purchase for warranty and servicing purposes.

### **REPLACEMENT PARTS**

Replacement parts for this product are available at our authorized King Canada service centers across Canada.

### **LIMITED TOOL WARRANTY**

King Canada makes every effort to ensure that this product meets high quality and durability standards. King Canada warrants to the original retail consumer a 2-year limited warranty as of the date the product was purchased at retail and that each product is free from defects in materials. Warranty does not apply to defects due directly or indirectly to misuse, abuse, normal wear and tear, negligence or accidents, repairs done by an unauthorized service center, alterations and lack of maintenance. King Canada shall in no event be liable for death, injuries to persons or property or for incidental, special or consequential damages arising from the use of our products.

To take advantage of this limited warranty, return the product at your expense together with your dated proof of purchase to an authorized King Canada service center. Contact your retailer or visit our web site at [www.kingcanada.com](http://www.kingcanada.com) for an updated listing of our authorized service centers. In cooperation with our authorized serviced center, King Canada will either repair or replace the product if any part or parts covered under this warranty which examination proves to be defective in workmanship or material during the warranty period.

### **ITEMS NOT COVERED UNDER WARRANTY**

Accessories supplied with this vacuum such as the hose, 14" floor sweep, crevice tool, gulper tool, cartridge filter and foam filter are not covered under warranty and are available as optional accessories at your nearest King Canada distributor.

---

## IMPORTANT SAFETY RULES FOR WET•DRY VACUUMS

**VOLTAGE WARNING:** Before connecting this vacuum to a power source (receptacle, outlet, etc.) be sure the voltage supplied is the same as that specified on the nameplate. A power source with voltage greater than the specified voltage on nameplate can result in **SERIOUS INJURY** to the user - as well as damage to the motor. If in doubt **DO NOT PLUG IN THE VACUUM**. Using a power source with voltage less than the nameplate is also harmful to the motor.

- 1. KNOW YOUR VACUUM.** Read and understand the instruction manual and labels affixed to the vacuum. Learn its application and limitations as well as its specific potential hazards.
- 2. WEAR PROPER APPAREL.** Do not wear loose clothing, gloves, neckties or jewelry (rings, watch) because suction force could get them caught in the vacuum. Wear protective hair covering to contain long hair. Roll up long sleeves above the elbows.
- 3. Do NOT expose to rain,** this vacuum must be stored indoors.
- 4. Do not handle** the electrical plug or vacuum with wet hands.
- 5. Never use this vacuum** with any opening blocked, keep opening free of dust, hair, lint or anything that will restrict air flow.
- 6. Never vacuum anything that is on fire,** burning or smoking such as matches, cigarettes or hot ashes. Never vacuum flammable or combustible liquids such as gasoline, electrical devices could produce sparks which can cause a fire or explosion! Never vacuum toxic or hazardous materials.
- 7. Never use this vacuum** without filters installed.
- 8. Never vacuum coal ash,** cement or drywall dust without adequate filtration in place or you could damage the motor or the material could be exhausted back into the air. When vacuuming drywall dust, a high efficiency drywall filter must be used to prevent serious motor damage. These high efficiency accessories are available and are listed in this manual.

# GETTING TO KNOW YOUR VACUUM, ELECTRICAL INFO & SPECIFICATIONS



## GETTING TO KNOW YOUR VACUUM

- 1) Switch
- 2) 2-1/2" flex hose
- 3) Contour handle with air control
- 4) Transportation handle with soft-grip
- 5) Power cord/cord wrap (1 of 2)
- 6) Accessory storage bag
- 7) Cover/motor latch (1 of 2)
- 8) 2pc. 2-1/2" extension wands
- 9) Stainless steel tank
- 10) On-board accessory storage tray
- 11) 14" floor sweep with squeegee insert
- 12) Locking caster wheel
- 13) Cartridge filter
- 14) Crevice tool
- 15) Gulper tool
- 16) Foam filter
- 17) Tank drain cap
- 18) Blower outlet/noise diffuser

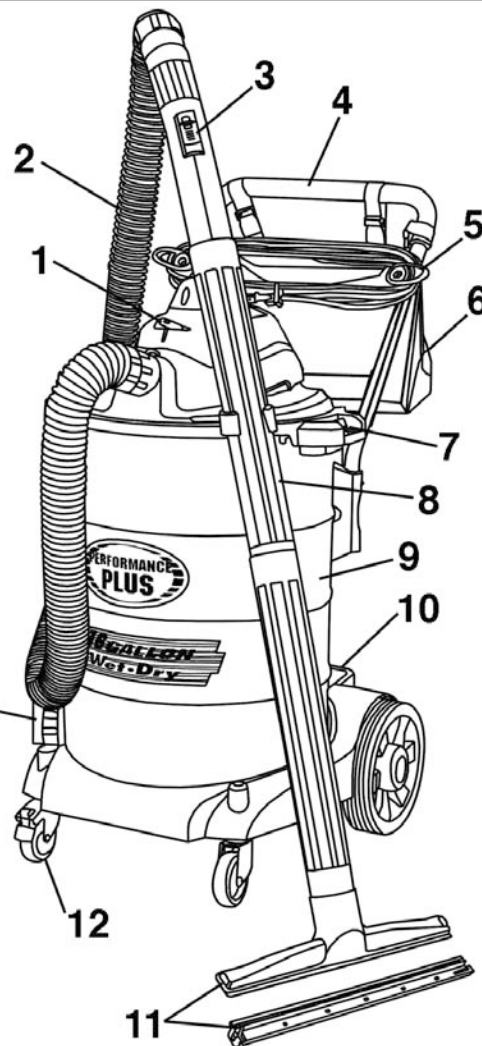
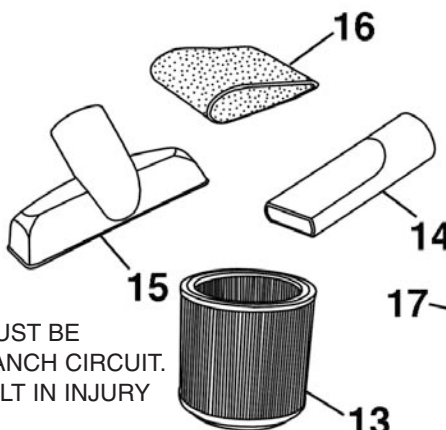
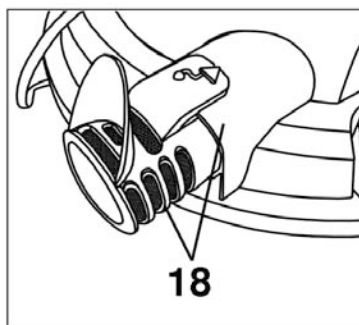

## ELECTRICAL INFO

**POWER SUPPLY- WARNING:** YOUR VACUUM MUST BE CONNECTED TO A 110V, MINIMUM 15-AMP. BRANCH CIRCUIT. FAILURE TO CONNECT IN THIS WAY CAN RESULT IN INJURY FROM SHOCK OR FIRE.

**DOUBLE INSULATED-GROUNDING NOT REQUIRED, WHEN SERVICING USE ONLY IDENTICAL REPLACEMENT PARTS.**

**POLARIZED PLUG-** Double insulated tools are equipped with a polarized plug (one blade is wider than the other), refer to Fig.1. This plug will fit in a polarized outlet only one way. If the plug does not fit fully into the outlet, reverse the plug. If it still does not fit, contact a qualified electrician to install a proper outlet. Do not alter or change the plug in any way. Double insulation eliminates the need for three wire grounded power cords and grounded power supply system.

**110V OPERATION-** As received from the factory, your vacuum is ready to run for 110V operation. This vacuum is intended for use on a circuit that has an outlet and a plug which looks like the one illustrated in Fig.1.

**EXTENSION CORDS-** The use of any extension cord will cause some loss of power. Use the table in Fig.2 to determine the minimum wire size (A.W.G.-American Wire Gauge) extension cord needed. For circuits that are further away from the electrical circuit box, the wire size must be increased proportionately in order to deliver ample voltage to the motor. Refer to Fig.2 for wire length and size.

POLARIZED OUTLET

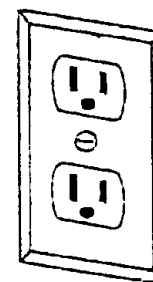

POLARIZED PLUG



FIGURE 1

LENGTH OF CONDUCTOR	WIRE SIZES REQUIRED (AMERICAN WIRE GAUGE)
	110V LINES
0-25 FEET	NO.16
26-50 FEET	NO.16
51-100 FEET	NO.14

FIGURE 2

### SPECIFICATIONS

Model.....	8560LST
Voltage.....	110V
Horsepower .....	6.5 HP (peak)
Amperage.....	10.5A
Phase.....	1
Hertz .....	60Hz
Tank size .....	16 Gallon (US)/60 liters
Air flow .....	229 CFM



# UNPACKING & ASSEMBLING YOUR VACUUM

**ATTENTION!** The vacuum accessories are packed inside the vacuum tank.

## UNPACKING YOUR VACUUM

Remove the entire contents of the carton, please note that most of the accessories are packed inside the vacuum tank. To access these accessories, push the cover latches (step 1) Fig.3 inward, lift the tank cover/motor assembly (step 2) and then remove the accessories inside the tank.



Figure 3

**WARNING!** DO NOT CONNECT THE POWER CORD TO THE POWER SOURCE UNTIL THE FOLLOWING ASSEMBLY AND SET-UP INSTRUCTIONS HAVE BEEN DONE.

## ASSEMBLING LARGE WHEELS AND CASTER WHEELS

Two large 8" wheels and two caster wheels are included and should be assembled to the bottom of the base.

- 1) With the tank cover/motor assembly removed, turn the tank upside down. Insert the caster wheels into the two openings in the base and apply pressure until casters snap into place.
- 2) To assemble the large wheels to the base, first insert the wheel shaft (A) Fig.4 into the rear support block, slide a washer (B) on the shaft, then slide wheel (C) on the shaft, then another washer (B). Insert cotter pin (D) into the hole at the end of the shaft to lock wheel. Snap the wheel hub (E) onto the wheel. Repeat these steps to install the other wheel.

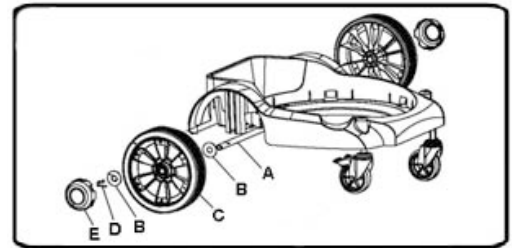

Figure 4

## TRANSPORT HANDLE ASSEMBLY

A transport handle is included and should be assembled to the mounting brackets on the sides of the stainless steel tank assembly.

- 1) Insert both ends of the transport handle into the mounting brackets on the sides of the stainless steel tank, push down until each lock pin clicks in place. See Fig.5.



Figure 5

## NOISE DIFFUSER ASSEMBLY

For quiet operation, a noise diffuser is included and should be installed to the rear blower outlet.

- 1) Install the noise diffuser (A) Fig.6 into the blower outlet (B) by inserting the locking end and turning clockwise to lock it in place.

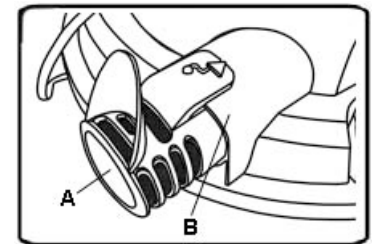

Figure 6

## ACCESSORY STORAGE BAG ASSEMBLY

An accessory storage bag is included and should be installed to the transport handle.

- 1) Install the storage bag to the transport handle using the retaining clips as shown in Fig.7.

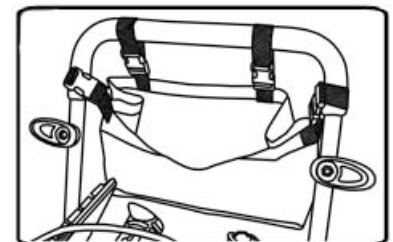

Figure 7

## HOSE, WANDS AND ACCESSORY ASSEMBLY

- 1) Install the locking end of the flex hose Fig.8 to the vacuum inlet (front of the vacuum) by inserting the locking end and turning clockwise to lock it in place.
- 2) Assemble the 2 extension wands and the contour handle with air control together and then attach the flex hose to the contour handle.
- 3) Attach either the floor sweep Fig.8, crevice tool or gulper tool to the other end of the extension wand assembly.

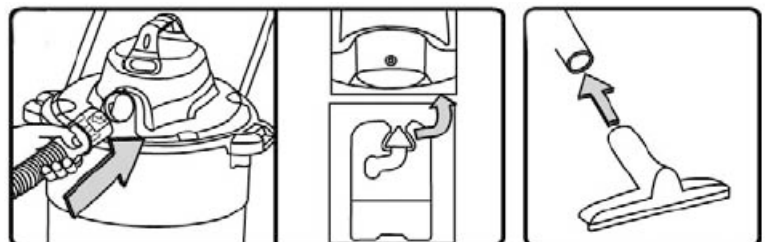

Figure 8

# OPERATION



## INSTALLING THE CORRECT FILTER FOR THE APPLICATION

Before reinstalling the cover/motor assembly on, it is important to determine the desired cleaning application, wet or dry vacuuming. Each cleaning application requires different types of filters.

## DRY VACUUMING OPERATIONAL STEPS

**Before vacuuming dry materials, it is important that you have read and understood the safety rules in this manual.**

- 1) Unplug the power cord from the power source.
- 2) Remove the cover/motor assembly, for normal vacuuming operation, a clean and dry foam filter should be installed. If the vacuuming operation is extremely dusty, a clean and dry cartridge filter should be installed. Slide the foam filter (A) Fig.9 or the cartridge filter (B) over the cage (C). If it is necessary to vacuum dry materials and you have just finished vacuuming wet materials, the foam or cartridge filter must be completely dried or else they will clog up quickly and will be difficult to clean. The foam or cartridge filter can be dried quickly by running the vacuum for 5-10 minutes without the hose installed.
- 3) Reposition and secure the cover/motor assembly to the tank.
- 4) Attach the flex hose to the inlet on the front of the vacuum.
- 5) Assemble the 2 extension wands and the contour handle together and then attach hose to contour handle.
- 6) Attach either the floor sweep, crevice tool or gulper tool to the other end of the extension wand.
- 7) Plug the power cord to a 110V power source.
- 8) Start the vacuum by pushing the On/Off switch to the On position as shown in Fig.10. The On position is indicated by the international symbol "I" on the switch.
- 9) Once the vacuuming operation is finished, push the switch to the Off position indicated by the international symbol "O" on the switch and unplug the power cord from the power source.
- 10) Remove the cover/motor assembly and lay it aside, being careful not to damage the filter and dump the tank contents into a suitable waste disposal container. **Airborn dust will be produced when cleaning, wear dust mask!**

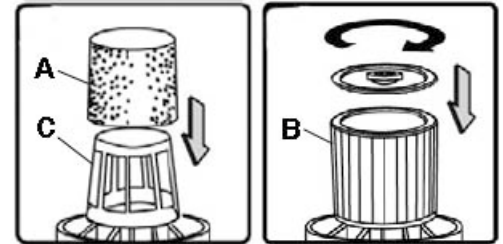
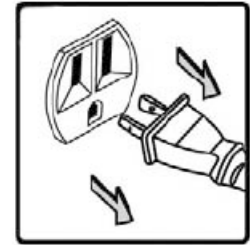

Figure 9

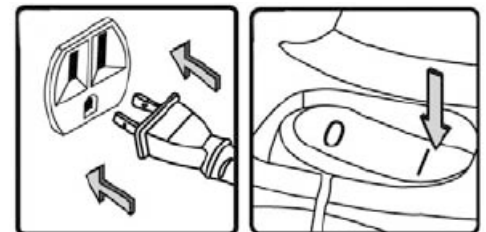

Figure 10

### Warning!

Never use the cartridge filter for vacuuming wet materials. When vacuuming fine dust, it will be necessary to clean the foam and cartridge filters at more frequent intervals.

## WET VACUUMING OPERATIONAL STEPS

**Before vacuuming wet materials, it is important that you have read and understood the safety rules in this manual.**

- 1) Unplug the power cord from the power source.
- 2) Remove the cover/motor assembly and install a clean and dry foam filter. If wet vacuuming under normal conditions or when vacuuming large amounts of liquid, only install the foam filter, slide the foam filter (A) Fig.11 over the cage (B). Make sure the inside of the tank is clean.
- 3) Reposition and secure the cover/motor assembly.
- 4) Attach the flex hose to the inlet on the front of the vacuum.
- 5) Assemble the 2 extension wands and the contour handle together and then attach hose to contour handle.
- 6) Attach either the floor sweep, crevice tool or gulper tool to the other end of the extension wand. For wet applications, remove the brush insert from the floor sweep by pressing the 2 snap points at each end of the floor sweep, the assembly will pop out, replace it with the squeegee insert and snap it back into the floor sweep.
- 7) Plug the power cord to a power source.
- 8) Start the vacuum by pushing the On/Off switch to the On position as shown in Fig.12. The On position is indicated by the international symbol "I" on the switch.
- 9) When vacuuming large amounts of liquid, do not completely immerse the nozzle accessory in the liquid, leave a gap at the top of the nozzle accessory opening to allow air inflow.
- 10) Once the vacuuming operation is finished, push the switch to the Off position indicated by the international symbol "O" on the switch and unplug the power cord from the power source.

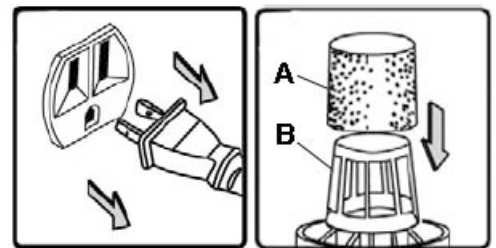

Figure 11

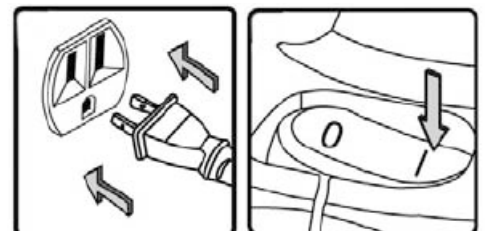

Figure 12

### Warning!

Never use the cartridge filter for vacuuming wet materials.

The foam filter should be cleaned after each wet vacuuming operation.

Should it become necessary to pick up the vacuum to move it, DO NOT pick up the vacuum by the top handle unless the tank is empty. Do not pull the vacuum by the hose, this may tip the vacuum over if the wheels are obstructed in any way.



# OPERATION & MAINTENANCE

## AUTOMATIC SUCTION SHUT-OFF AND EMPTYING LIQUID FROM TANK

This section relates to wet vacuuming operations. This vacuum is fitted with an automatic suction shut-off float cup (A) Fig.13 which floats up when the liquid level increases in the tank, it then stops the suction action when the tank has reached its maximum capacity of liquid. Make sure the float cup is clean at all times.

**The user will notice an increased motor speed, when this happens;**

- 1) Turn off the vacuum immediately and unplug the power cord from the power source.
- 2) Remove the cover/motor assembly and lay it aside, being careful not to damage the filter and empty the tank contents into a suitable waste disposal container by removing the drain cap (A) Fig.14 found on the lower left side of the tank.
- 3) The inside of the tank should be cleaned, also check the foam filter and clean it from the inside out if necessary.
- 4) To continue vacuuming wet materials, reposition and secure the cover/motor assembly, plug the power cord to a power source and proceed.

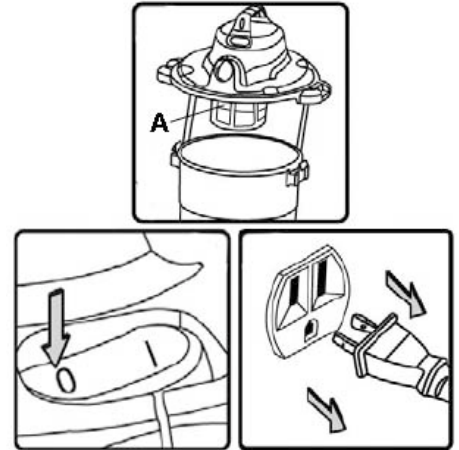

Figure 13

## BLOWER FEATURE

This vacuum can be used as a powerful blower. To use the blower feature, remove the noise diffuser (A) Fig.15 from the blower outlet (B). Disconnect the flex hose from the front of the vacuum and reconnect it to the blower outlet. Turn the vacuum On, your vacuum is now a blower to clear work tables of debris, blow leaves etc...

## STANDARD AND OPTIONAL ACCESSORIES

The following chart lists the standard accessories included and the available optional accessories for this wet-dry vacuum. Please note that these accessories are not covered under warranty and are available at your nearest King Canada distributor.

Model	Description	Usage	Included/Optional
KVAC-1040	Foam Filter- 1pc.	Wet•Dry Vacuuming Applications	1pc. Included
KVAC-1075	Cartridge Filter- 1pc.	Dry Vacuuming Applications	1pc. Included
KVAC-1104	2-1/2" Gulper Tool- 1pc.	General purpose	1pc. Included
KVAC-1106	2-1/2" Crevice Tool- 1pc.	Upholstery and car interiors	1pc. Included
KVAC-1108	14" x 2-1/2" Floop Sweep- 1pc.	General purpose-squeegee attachment	1pc. Included
KVAC-1115	2pc. Extension wands	Replacement kit	2pc. Included
KVAC-1123	Caster Wheels- 2pc. kit	Replacement kit	2pc. Included
KVAC-1140	High Efficiency Cartridge Filter	Drywall and fine dust applications	Optional

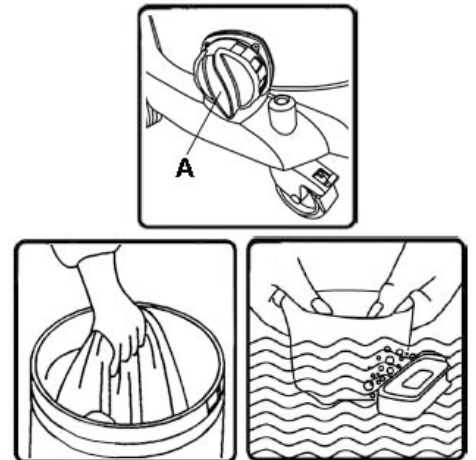

Figure 14

## ON-BOARD ACCESSORY STORAGE

When the 14" floor sweep, crevice tool or gulper tool are not in use, they can be stored in the on-board storage on the top of the motor cover or the accessory storage bag as shown in Fig.16.

## MAINTAINING YOUR VACUUM AND ACCESSORIES

**Warning! To reduce the risk of injury and electrical shock, unplug the power cord from the power source. Airborn dust will be produced when cleaning, wear dust mask!**

To maintain peak vacuum performance, the cartridge and foam filters must be cleaned often. When not in use, wrap the power cord around the power cord posts as shown in Fig.17.

**Filter maintenance-** Clean the foam filter by washing it inside out in a mild soapy water and then rinse with clean water. Clean the cartridge filter in a mild soapy water and then rinse with clean water. Allow these filters to dry completely before using.

**General Maintenance and Inspection-** The inside of the tank, hose, extension wands and accessories should be cleaned after every use, this cleaning should only be done outdoors with the power cord disconnected from the power source. Check the condition of the power cord and make sure it is not damaged. Also check the condition of the filters for tears and small holes. Do not use filters with tears or small holes, replace with new filters.

## PARTS DIAGRAM & PARTS LISTS

Refer to the Parts section of the King Canada web site for the most updated parts diagram and parts list.

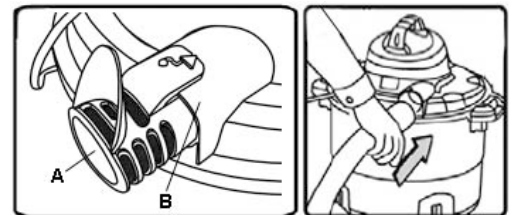

Figure 15

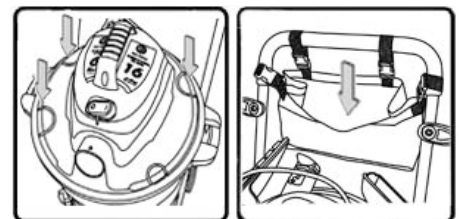

Figure 16

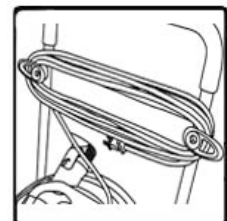

Figure 17